

FOR LEASE > INDUSTRIAL

45A STREET E

UNIT 510A, SASKATOON, SK



Great central north end space located just off Faithfull Avenue. Property has easy access to 51st Street, Circle Drive, Idylwyld Drive, Highways 16, 11 and 12 and Saskatoon John G. Diefenbaker International Airport.

BUILDING PARTICULARS

- > Wide open warehouse space
- > New 10' grade overhead door
- > LED lights
- > Rear man door
- > Hanging heater
- > Ceiling height: 11.5 feet clear
- > Parking: common to site
- > Barrier-free washroom

AREA FOR LEASE

2,271 SF

ZONING

IL1

NET ASKING RATE

\$12.50 PSF

OCCUPANCY COSTS

\$4.83 PSF (2025 Budget)

POSSESSION

March 1, 2026

KYLE GERWING
Director of Development & Leasing
306 717 9893
kgerwing@concordegroupp.com

300-1507 Eighth Street East
Saskatoon SK S7H 0T2
306 668 3004
www.cgcproperties.com

CONCORDE
PROPERTIES

UNIT 510A 45A STREET E

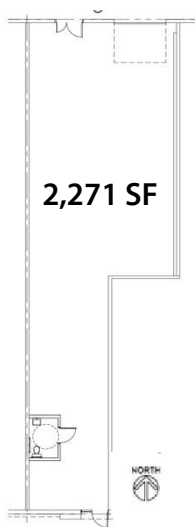
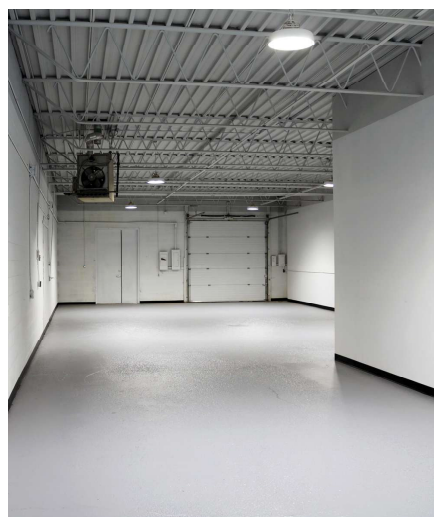
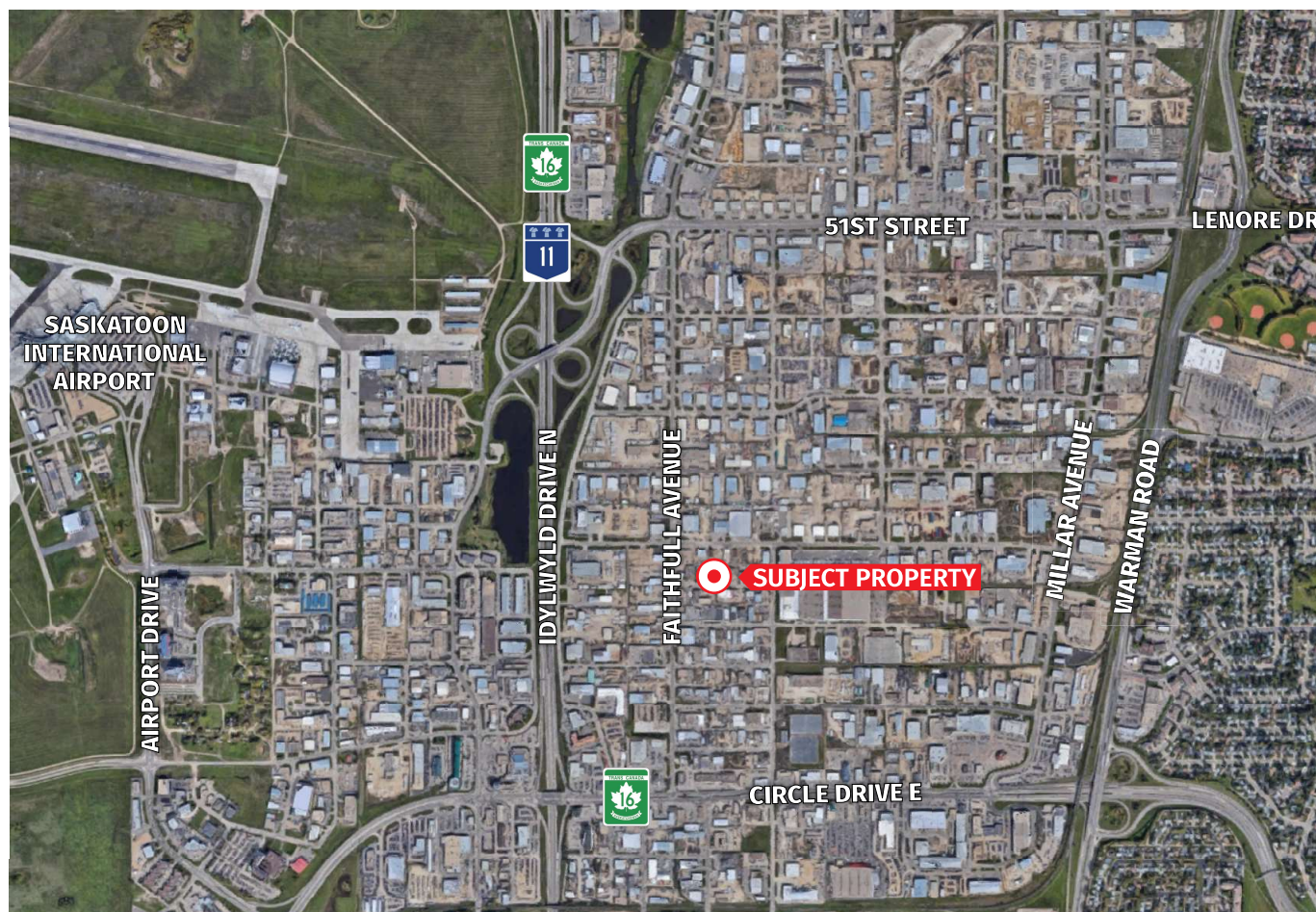

KYLE GERWING
Director of Development & Leasing
306 717 9893
kgerwing@concordegroupp.com

300-1507 Eighth Street East
Saskatoon SK S7H 0T2
306 668 3004
www.cgcproperties.com

CONCORDE
PROPERTIES