

FOR LEASE > WAREHOUSE/RETAIL

HERITAGE BUSINESS PARK

UNITS 303/304 2750 FAITHFULL AVENUE, SASKATOON, SK



Heritage Business Park is located on the corner of Faithfull Avenue and 51st Street in Saskatoon. This premium location allows for easy access to Circle Drive, Idylwyld Drive, Highways 16, 11 and 12 and Saskatoon John G. Diefenbaker International Airport. Units 303-304 are situated behind Heritage Business Park with access to 50th Street.

BUILDING PARTICULARS

- > 3 overhead dock height doors
- > 21' clear span ceiling
- > Reception, office and retail area at front of space
- > Excellent access and location at corner of 51st St & Faithfull
- > Ideal space for logistics & distribution

AREA FOR LEASE

7,199 SF

ZONING

IL1

LEASE RATE

\$11.50 PSF

OCCUPANCY COSTS

\$6.83 PSF

POSSESSION

Immediate

KYLE GERWING

Director of Development & Leasing
306 717 9893
kgerwing@concordegroupp.com

300-1507 Eighth Street East
Saskatoon SK S7H 0T2
306 668 3004
www.cgcproperties.com

CONCORDE
PROPERTIES

UNITS 303/304 2750 FAITHFULL AVENUE

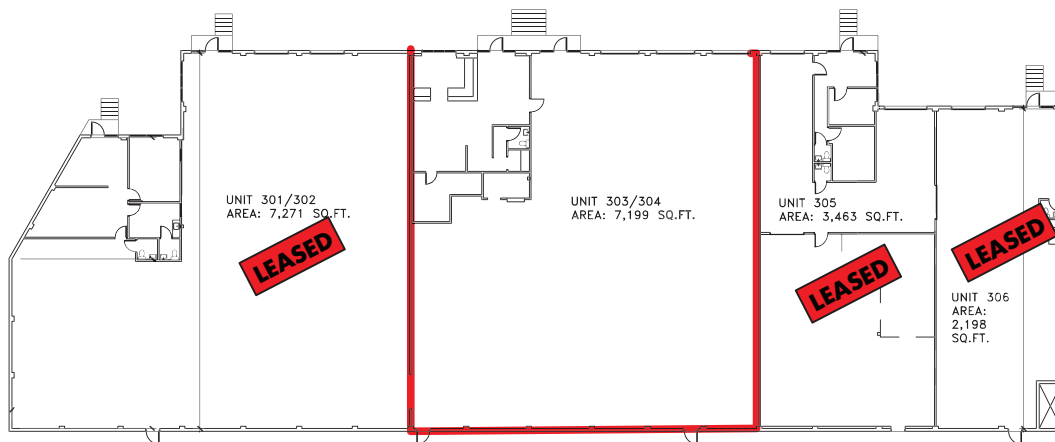

KYLE GERWING
Director of Development & Leasing
306 717 9893
kgerwing@concordegroupp.com

300-1507 Eighth Street East
Saskatoon SK S7H 0T2
306 668 3004
www.cgcpproperties.com

CONCORDE
PROPERTIES